

User Manual

Contents

Preface.....	2
Feature.....	3
Preparation.....	4
On and Off function.....	4
How to wear your hearing instrument.....	4
Operation.....	5
Volume control.....	5
Memory switch.....	5
Trimmer cover.....	6
Trimmers.....	6
Low battery warning.....	7
Replacing the battery.....	7
Maintenance.....	8
Trouble shooting guide.....	8
Battery care.....	9
Cleaning.....	9
Appendix.....	10
Technical information	10
FDA Information	11

Preface

Congratulations on becoming the new owner of our flagship hearing aid, the HC 62! We think you will find the perfect mix of price and quality.

Please take the time to carefully read through this manual so you can become knowledgeable in how to use the hearing aid as well as its various functions!

Welcome to the Advanced Affordable Hearing family!

Intended use

Hearing aids help people with diminished hearing by amplifying the sounds around them and feeding it directly into the ear. The amplification helps to compensate for hearing loss allowing you to connect more clearly with those around you.

Scope

This user manual is only intended to be used with the Advanced Affordable Hearing HC 62 hearing aid.

Precautions

If you have an ear infection it is highly recommended that you do not wear a hearing aid until the infection has cleared up. Please consult with a hearing healthcare professional or your doctor prior to resuming use.

THE MANUFACTURER RESERVES THE RIGHT TO MODIFY THE TECHNICAL SPECIFICATIONS OF THIS PRODUCT WITHOUT ANY PRIOR NOTICE

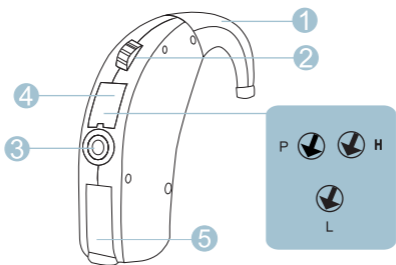

- 1.Earhook
- 2.Volume Control
- 3.Memory Switch
- 4.Trimmer Cover
- 5.Battery Door

Preparation

ON and OFF function

Turn on your hearing instrument by closing the battery door completely.

Turn off your hearing instrument by opening the battery door slightly.

Note: Never force the battery door open or closed.

How to Wear Your Hearing Instrument

Insert your earmold (or eartip) correctly based on patient practices. Please consult your hearing healthcare professional when you have some difficulty in inserting the earmold.

Step 1. Hold the earmold (or eartip) by the outer side near the tubing with your thumb and forefinger. Insert the canal tip of the earmold into your ear canal gently. Then softly press the earmold into place with your fingertip.

Step 2. Carefully place the BTE behind your ear with the ear hook and earmold tubing wrapped over the top.

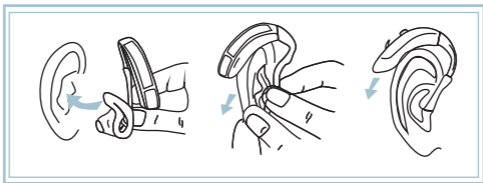

NOTE:

Before placing the BTE earmold (or eartip) into your ear canal, make sure the battery is inserted properly and the battery door is closed securely.

Volume Control

To adjust the volume, rotate the volume control by your fingertip up and down. The numbers indicate an orientation for the current volume setting.

To increase the volume, turn the volume control up. To decrease the volume, turn the volume control down.



Note: Before wearing the instrument, make sure that the volume is not at the maximum place. Adjust volume gradually according to your own hearing requirement to avoid feedback and protect your hearing.

Memory switch

The HC 62 hearing aid has three preprogrammed settings that differ in the amount of amplification at specific frequencies. The majority of users will find that one of the settings better suits their needs. When you press the Program Button, you will hear either one, two, or three beeps, indicating which program you are in. You are free to choose which one fits you best.

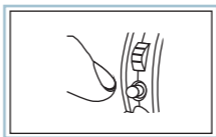

Trimmer Cover

Pre-set controls are placed under the cover.

The trimmer cover should always remain closed to prevent dirt and moisture from entering the instrument.

Open:

Pull the top of the cover with the nail of your forefinger.

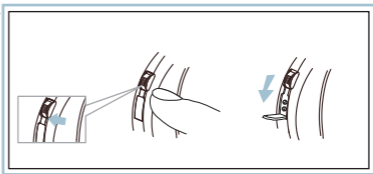

Close:

Just Push the trimmer cover downward gently.

Trimmers

H Trimmer:

Used to eliminate noise.

Turn clockwise for maximum high-frequency sound, minimum feedback reduction.



L Trimmer:

Used to eliminate feedback.

Turn clockwise for maximum low-frequency sound, minimum noise reduction.



P Trimmer:

Controls the maximum output sound level.
Turn clockwise for maximum sound amplification.



Low Battery Warning

When you hear one short beep, it means that the battery is running out. Intermittent warning exists until you replace the battery.

The sound quality may be influenced after the first warning, this is normal and can be remedied by inserting a fresh battery in the hearing instrument.

Always remove the battery if your instrument is not in use for long periods.

Replacing the battery

1. Switch off the hearing instrument by opening the battery door.
2. Remove the old battery out of door.
3. Remove the protective foil from the new battery.
4. Insert the new battery with the plus (+) up as shown below.
5. Close the battery door.

Important: Handle the battery door gently. The operation requires only a minimum force. If there is any resistance when closing the battery door, ensure that the battery is correctly inserted. The battery door cannot be closed if the battery is inserted incorrectly.

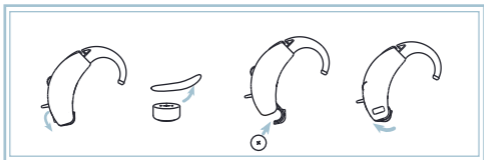

Troubleshooting

SYMPTOM	POSSIBLE CAUSES	SOLUTIONS
No sound	No battery	Insert battery
	Dead or low battery	Replace battery
	Battery improperly inserted	Insert battery correctly
	Wax or debris in the ear mold or ear tip	Remove and clean the ear mold or ear tip
Not loud enough	Low battery	Replace battery
	Excessive ear wax	Consult your physician
	Volume set too low	Turn up the Volume Control
	Improper insertion of ear mold or ear tip	Remove and reinsert the ear mold or ear tip
	Hearing change	Contact your hearing care professional
Whistling, feedback	Improper insertion of ear mold or ear tip	Remove and reinsert the ear mold or ear tip
Not clear or distorted sound	Low battery	Replace battery
	Hearing instrument damaged	Contact Advancedhearing.com
	Hearing instrument settings not optimal	Contact Advancedhearing.com

Battery care

The performance of hearing instrument greatly depends on the quality of the battery using.

1. It is important to use high-quality batteries. With reliable high-quality batteries, you can avoid periodic hearing instrument failures.
2. It is also important that the batteries are well packed before use. Each battery is therefore provided with an adhesive label which ensures the battery is sealed and fresh till use.
3. Never leave an exhausted battery in the hearing instrument. Exhausted battery may leak and it would damage the instrument.

Cleaning

Ear wax is one of the main causes of problems with hearing aids. Filter and other devices are used for preventing wax from entering the instrument.

Cleaning is easier when ear wax is dry in the morning before you insert the instrument to your ear.

Clean your instrument with a soft, dry cloth and a small brush. Do the cleaning on a soft table to avoid damage or scratch in case the instrument falls.

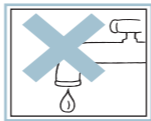

Do not use water or other fluids.

Appendix

Technical information

Testing diagram

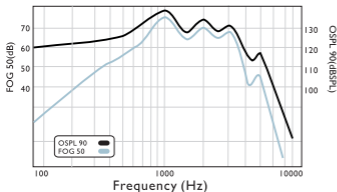

Technical Data

Technical Data	HC 62
Peak OSPL 90 (dB SPL)	139
HFA OSPL 90 (dB SPL)	133
Peak Gain (dB)	75
Reference Test Gain (dB)	66
HFA full on Gain (dB)	58
Total Harmonic Distort:	
500Hz (%)	1.5
800Hz (%)	1.0
1600Hz (%)	1.0
EQ Input Noise (dB)	25
Battery Current (mA)	1.34
Frequency Range	200-5500

ANSI S3.22-2003

Special Statements

> Hearing aids will not restore normal hearing and will not prevent or improve a hearing impairment resulting from organic conditions.

> Allergic reactions to hearing aids are unlikely. However, if you experience itching, redness, soreness, inflammation or a burning sensation in or around your ears, inform your hearing health care professional and contact your physician.

> The use of hearing aids is only part of hearing rehabilitation; auditory training and lip reading instruction may be required as well.

> In most cases, infrequent use of hearing aids does not provide full benefit. Once you have become accustomed to your hearing aids, wear your hearing aids everyday all day.

> Hearing aids can be damaged by dropping them or getting them wet.

> If your hearing aid needs to be repaired, please call Toll Free **1-888-570-2740** to obtain a Repair Authorization number and instructions on where to send the hearing aid. You may send the hearing aid to Advanced Affordable Hearing, LLC c/o IMHear Corp, 2711B Curtiss St, Downers Grove, IL 60515, but if you do you will incur additional Service Charges.

FDA Information

Warning to Hearing Aid Dispensers

A hearing aid dispenser should advise a prospective hearing aid user to consult promptly with a licensed physician (preferably an ear specialist) before dispensing a hearing aid if the hearing aid dispenser determines through inquiry, actual observation, or review of any other available information concerning the prospective user, that the

prospective user has any of the following conditions: (i) Visible congenital or traumatic deformity of the ear. (ii) History of active drainage from the ear within the previous 90 days. (iii) History of sudden or rapidly progressive hearing loss within the previous 90 days. (iv) Acute or chronic dizziness. (v) Unilateral hearing loss of sudden or recent onset within the previous 90 days. (vi) Audiometric air-bone gap equal to or greater than 15 decibels at 500 hertz (Hz), 1,000 Hz, and 2,000 Hz. (vii) Visible evidence of significant cerumen accumulation or a foreign body in the ear canal. (viii) Pain or discomfort in the ear.

Important notice for prospective hearing aid users Good health practice requires that a person with a hearing loss have a medical evaluation by a licensed physician (preferably a physician who specializes in diseases of the ear) before purchasing a hearing aid. Licensed physicians who specialize in diseases of the ear are often referred to as otolaryngologists, otologists or otorhinolaryngologists. The purpose of medical evaluation is to assure that all medically treatable conditions that may affect hearing are identified and treated before the hearing aid is purchased.

Following the medical evaluation, the physician will give you a written statement that states that your hearing loss has been medically evaluated and that you may be considered a candidate for a hearing aid. The physician will refer you to a audiologist or a hearing aid dispenser, as appropriate, for a hearing aid evaluation. The audiologist or hearing aid dispenser will conduct a hearing aid evaluation to assess your ability to hear with and without a hearing aid. The hearing aid evaluation will enable the audiologist or dispenser to select and fit a hearing aid to your individual needs.

If you have reservations about your ability to adapt to amplification, you should inquire about the availability of a trial-rental or purchase-option program. Many hearing aid dispensers now offer programs that permit you to wear a hearing aid for a period of time for a nominal fee after which you may decide if you want to purchase the hearing aid. Federal law restricts the sale of hearing aids to those individuals who have obtained a medical evaluation from a licensed physician. Federal law permits a fully informed adult to sign a waiver statement declining the medical evaluation for religious or personal beliefs that preclude consultation with a physician. The exercise of such a waiver is not in your best health interest and its use is strongly discouraged.

Children with hearing loss

In addition to seeing a physician for a medical evaluation, a child with a hearing loss should be directed to an audiologist for evaluation and rehabilitation since hearing loss may cause problems in language development and the educational and social growth of a child. An audiologist who is qualified by training and experience to assist in the evaluation and rehabilitation of a child with hearing loss is recommended.



Advanced
Affordable Hearing

FDA **CE**₀₄₈₂ **MED**/CERT

Advanced Affordable Hearing, LLC.

Tel: 1-888-570-2740

Fax: 1-877-308-1820

Website: www.advancedhearing.com

Email: support@advancedaffordablehearing.com